

14002:003:0092
Tagasauna

14002:003:0093
Tagasauna

14002:003:0129
11207 Paunküla-Vetla tee

SIDEKAEVU TEHNILISED ANDMED

KAEVU NR.	KOORDINAADID		ABS. KÕRGUSED (m)			KAEVU LÄBIMÕÖT VÕI TÕÜP	KAEVU MATERJAL		TORUD						MÄRKUSED
	X	Y	MAAPIND	KAEVU KAAS	KAEVU PÕHI		SEINAD	KAAS	NR.	ABS. KÕRGUSED (m) LAGI/PÕHI	LÄBIMÕÖT	MATERJAL	SUUBUMINE	TRASSI PİKIVUS (m)	
1	2	3	4	5	6	7	8	9	10	11	12	13	14	15	16
C1531-M2	6563858.92	581879.35	68.24	68.24	67.44	KKS-1 800x800	plast	malm	1	67.59/67.54	1x50	PL			
									2	67.54/67.49	1x50	PL			
C1531-M3	6562654.40	581923.64	73.21	73.21	72.21	KKS-1 800x800	plast	malm	1	72.48/72.43	1x50	PL			
									2	72.49/72.44	1x50	PL			
C1531-M4	6563122.66	581798.03	70.62	70.62	69.85	KKS-1 800x800	plast	malm	1	69.91/69.86	1x50	PL			
									2	69.94/69.89	1x50	PL			

Märkused:
Ehitaja/tellija: Enefit AS
Koordinaadid L-EST97 süsteemis, kõrgused EH2000 süsteemis
Katastrüüksuste piirid: väljavõte Maa-ametist 30.07.2024. Kihil "PIIR" esitatud piirjoonte asukohad on informatiivsed.

TÖÖ NR	12174T	OBJEKT	Passiivse elektroonilise sidevõrgu rajamine VT2078		
TÖÖ KOOD	VT2078	AADDRESS	Harju maakond Anija vald Voose küla		
KOOSTAS	A. Sepp	FAIL	12174T Voose side VT2078		
MÕÕDISTAS	H. Harzia	MÕÕTKAVA	LEHT	JÕONIS	
MÕÕDISTATUD	30.07.2024	1:500	1 / 8	Teostusjoonis	

Kirjanurk
TEL003987 EEG000316 EEP004848
yld@kirjanurk.ee, rg-kood 12592543
Hievälja tee 20 Oru küla Kose vald Harjumaa

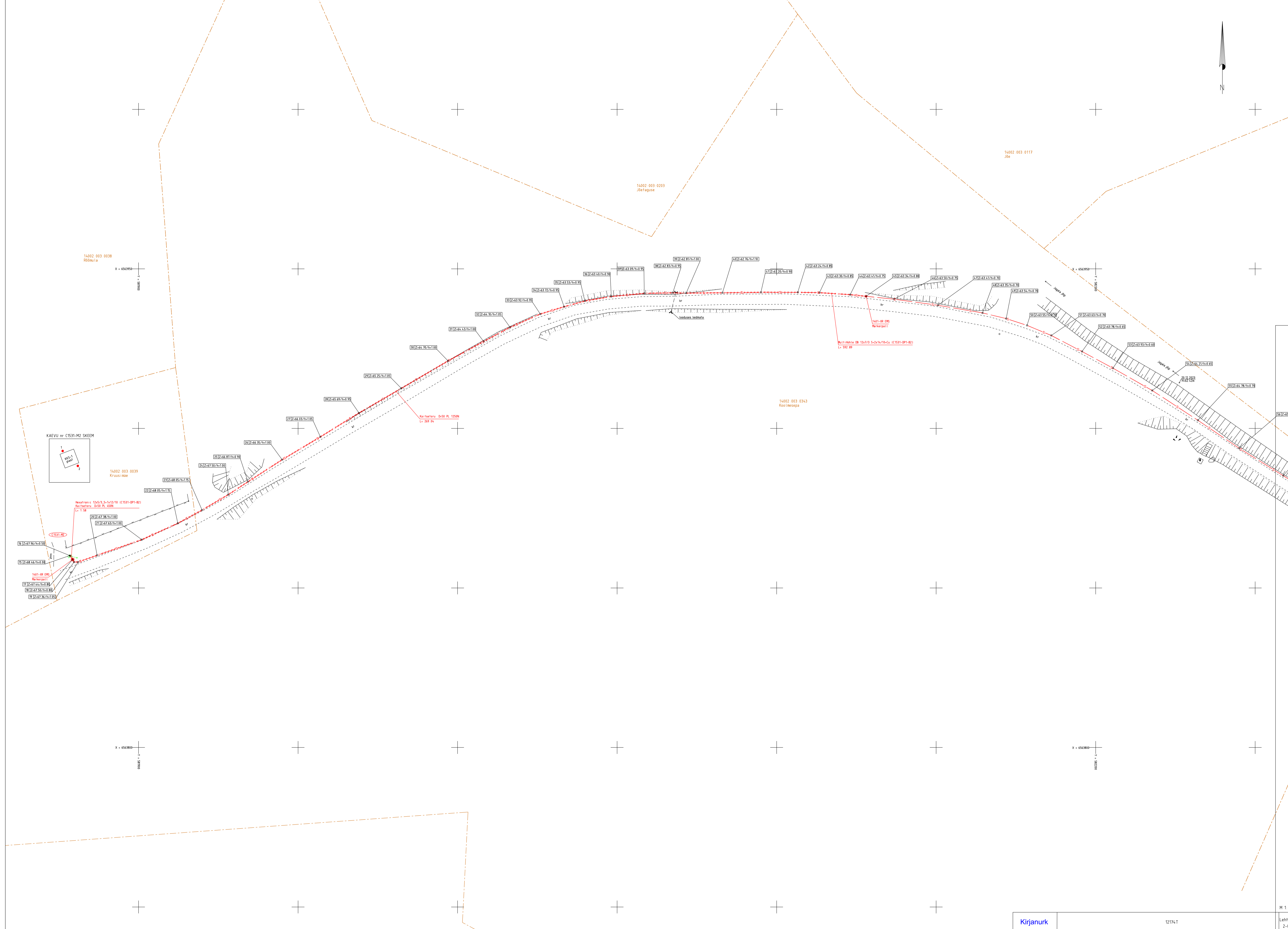
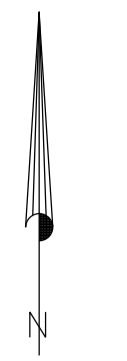

14002 003 0038
Rõõmula
X = 6563950

14002 003 0203
Jõe tagaosa

14002 003 0117
Jõe

X = 6563950

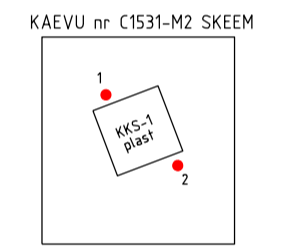

14002 003 0039
Kruusi ääres

Rekonstrueeritud 12x6,7/5-14,12/10 (C1531-0P1-B2)
Kaitseala: 0,20x0,15, 1000m
L= 1,58
1411-08 EMS
Kaitseala
512-47 37/7m-0 92
512-47 38/7m-0 92
512-47 39/7m-0 92

Kaitseala: 0,20x0,15, 1000m
L= 1,58

14002 003 0343
Kooli aed

22.12.2023
14:28:42

X = 6563800

X = 6563800

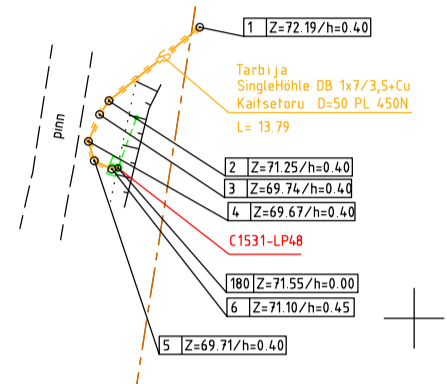
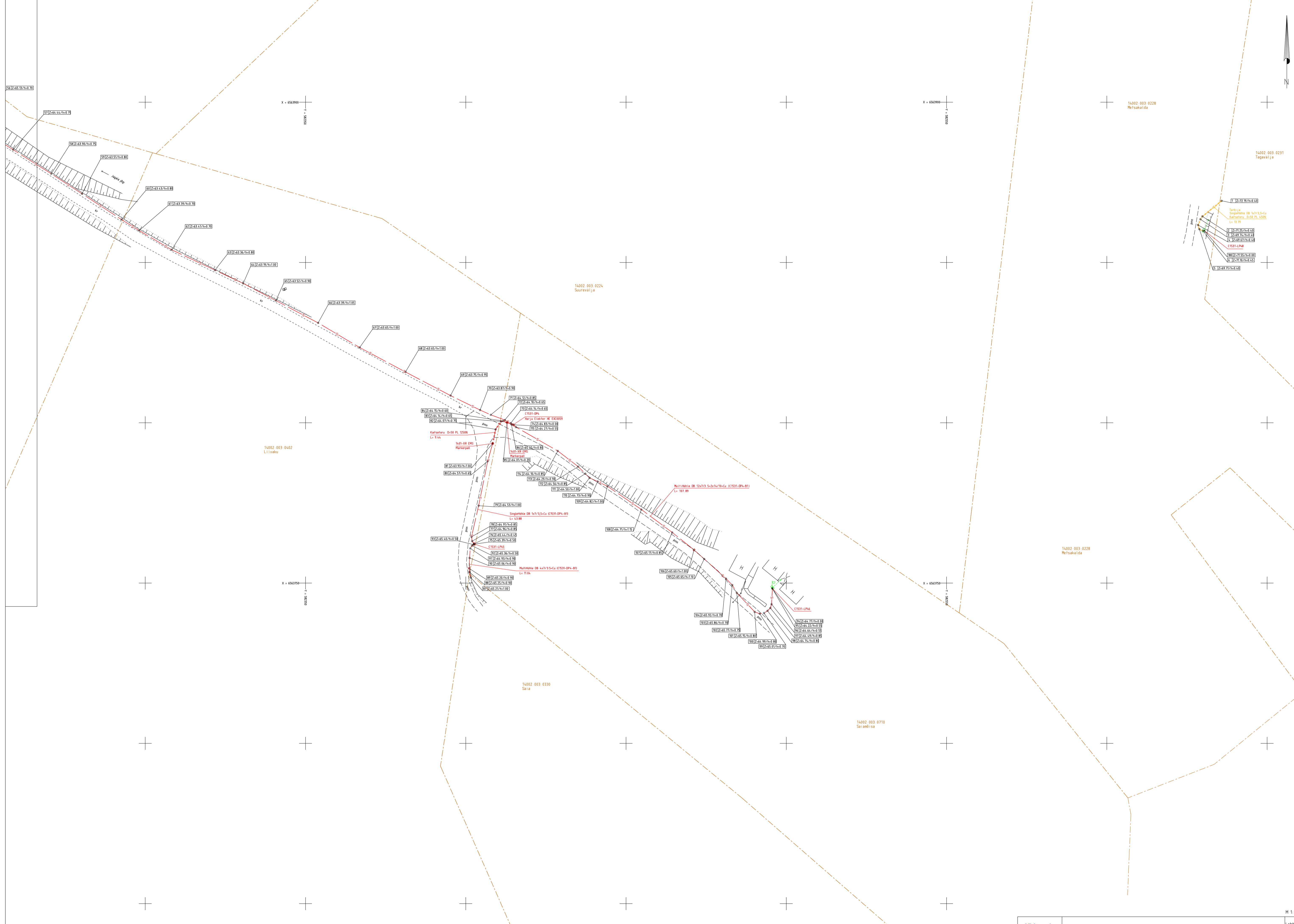
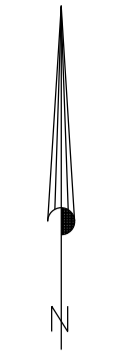

5372-45 13/h=0.70

5372-45 14/h=0.70

5372-45 15/h=0.70

5372-45 17/h=0.80

5372-45 18/h=0.80

5372-45 19/h=0.80

5372-45 20/h=0.80

5372-45 21/h=0.80

5372-45 22/h=0.80

5372-45 23/h=0.80

5372-45 24/h=0.80

5372-45 25/h=0.80

5372-45 26/h=0.80

5372-45 27/h=0.80

5372-45 28/h=0.80

5372-45 29/h=0.80

5372-45 30/h=0.80

5372-45 31/h=0.80

5372-45 32/h=0.80

5372-45 33/h=0.80

5372-45 34/h=0.80

5372-45 35/h=0.80

5372-45 36/h=0.80

5372-45 37/h=0.80

5372-45 38/h=0.80

5372-45 39/h=0.80

5372-45 40/h=0.80

5372-45 41/h=0.80

5372-45 42/h=0.80

5372-45 43/h=0.80

5372-45 44/h=0.80

5372-45 45/h=0.80

5372-45 46/h=0.80

5372-45 47/h=0.80

5372-45 48/h=0.80

14002 003 0402
Liiwaku

X = 656950
662000

14002 003 0330
Säia

14002 003 0224
Suurevalja

14002 003 0228
Metsakalda

14002 003 0710
Sairamõisa

14002 003 0228
Metsakalda

14002 003 0231
Tagavälja

14002 003
Metsakalda

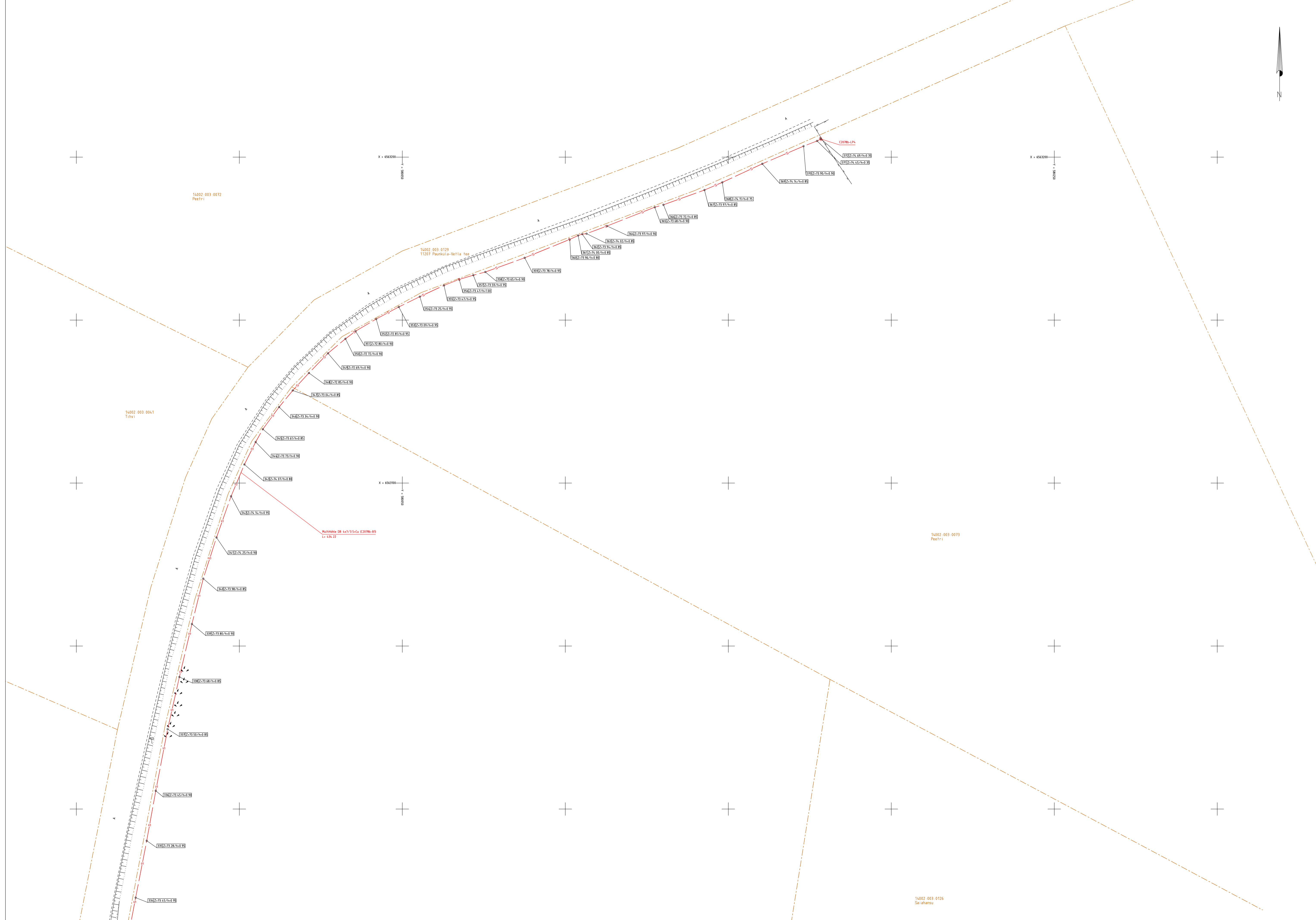
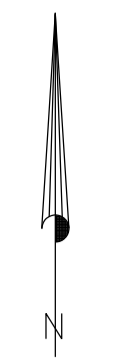

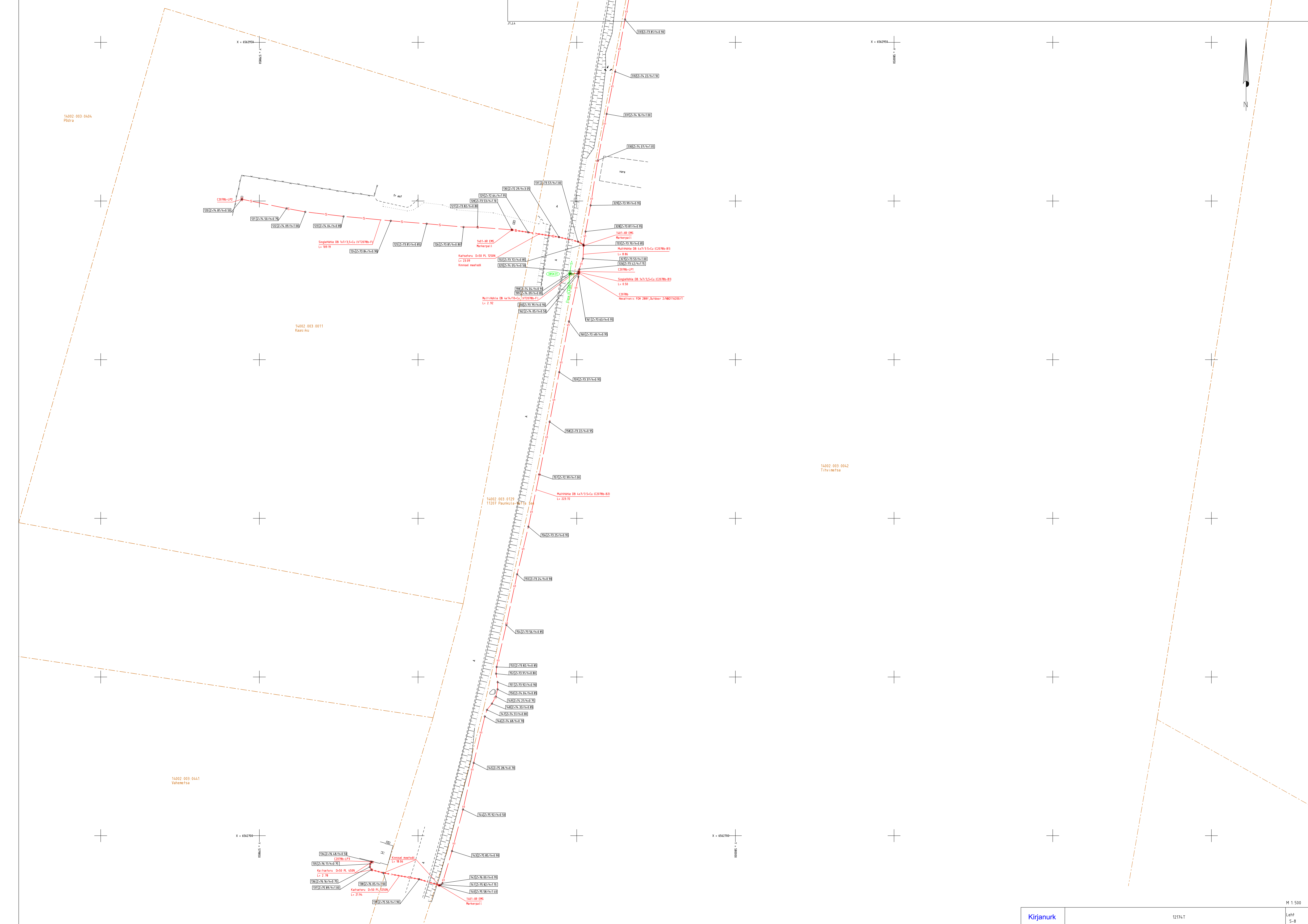

KAUVU nr C1531-M4-SKEEM

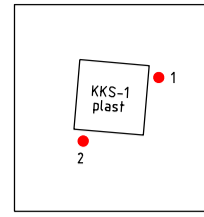

14002 003 0501
Tõrva

x = 4563700
000000 +

x = 4563100
000000 +

14002 003 0146
Tõnikse

14001 001 0984
Vana-Taijarve

14002 003 0037
Uuesuuna

14002 003 0502
Tõrva

x = 4562900
000000 +

x = 4562900
000000 +

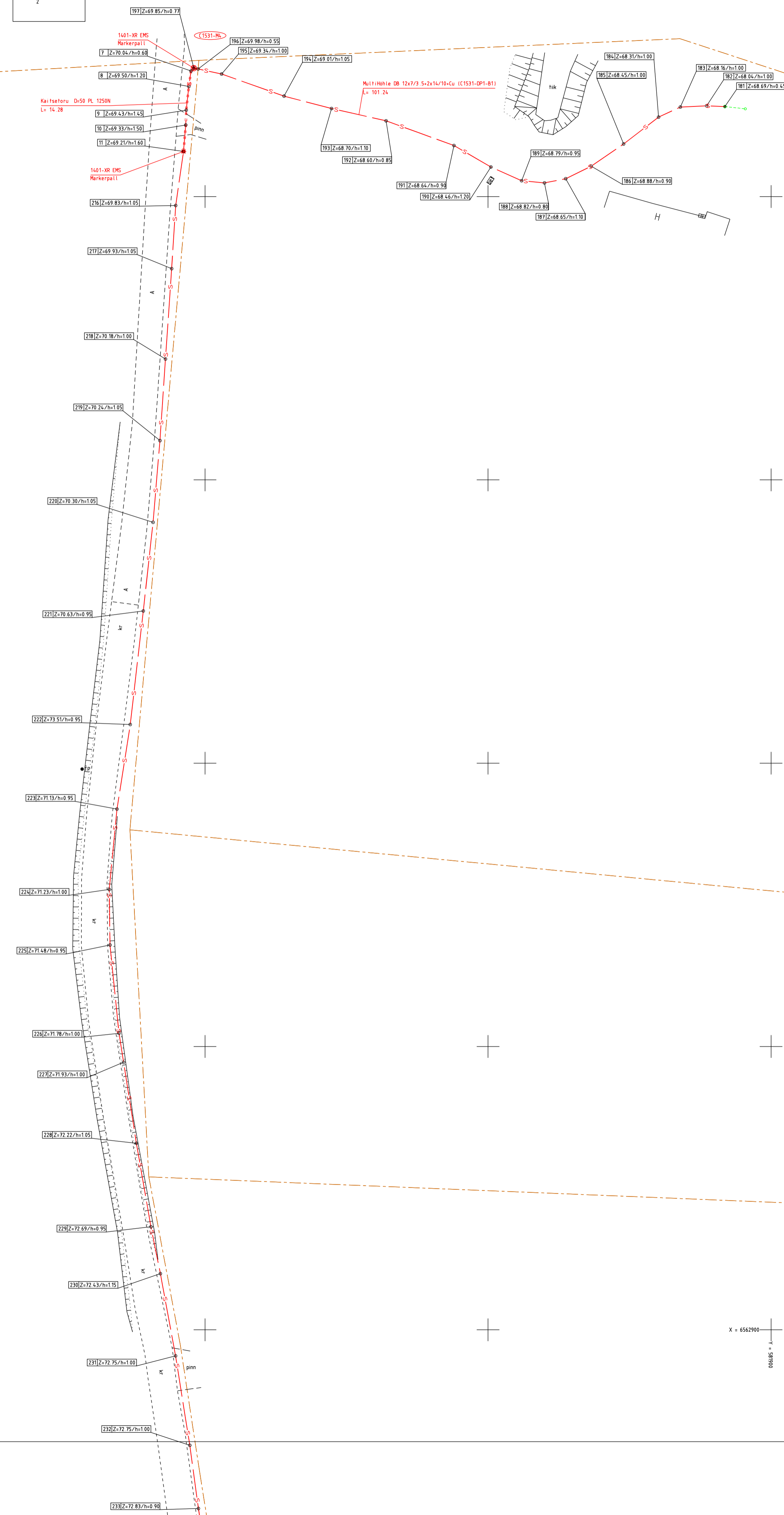

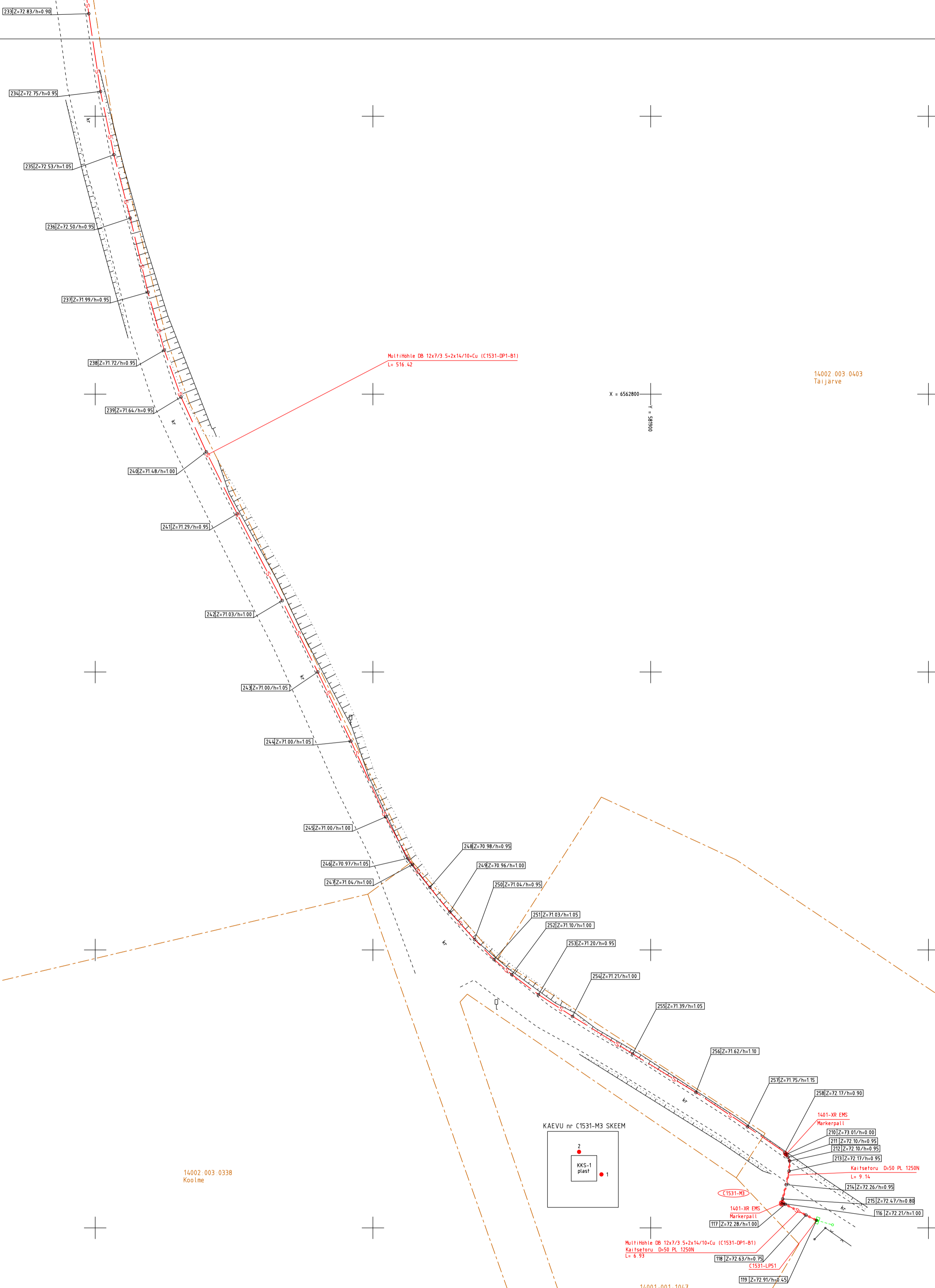
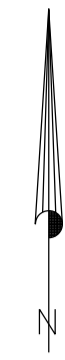

238Z-72.81/n=0.95

238Z-72.76/n=0.95

238Z-72.57/n=1.00

238Z-72.52/n=0.95

237Z-71.99/n=0.95

238Z-71.77/n=0.95

238Z-71.64/n=0.95

248Z-71.44/n=1.00

241Z-71.37/n=0.95

248Z-71.09/n=1.00

248Z-71.00/n=1.00

248Z-71.00/n=1.00

248Z-71.00/n=1.00

248Z-70.97/n=1.00

248Z-70.94/n=1.00

248Z-70.94/n=1.00

248Z-70.94/n=1.00

248Z-70.94/n=1.00

248Z-70.94/n=1.00

248Z-70.94/n=1.00

248Z-70.94/n=1.00

248Z-70.94/n=1.00

248Z-70.94/n=1.00

248Z-70.94/n=1.00

248Z-70.94/n=1.00

248Z-70.94/n=1.00

248Z-70.94/n=1.00

14002.003.0338
Kooline

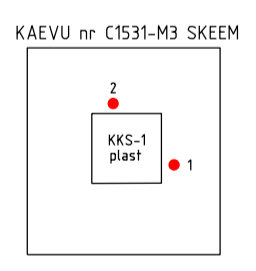

14001.001.1047
Riisli

14101.001.0453
Kurissaare Vee

14101.001.0478
Nirgu tee L1

14002.003.0403
Talljarve

14002.003.0430
Taaranee

14002.003.0034
Andrei

X = 456780

X = 456260

X = 456260

